

MF600

扁平式无齿轮
曳引机
FLAT
GEARLESS



主轴静载
static load
6000 kg

最大载重
load
up to 1600 kg

最大速度
speed
up to 2,5 m/s

曳引轮
sheave
450 - 480 - 550 mm

自重
weight
up to 720 kg

额定扭矩 Nominal Torque	极数 Poles	编码器 Encoder	编码器线 Encoder Cable	绝缘等级 Insulation Class	可选项 Optional
1470 Nm S5 - 40% ED	32	Haidenhain1387	7m	F	Motor power cable 7m
制动器 Brake					
DZD1-653 2X1550Nm-2x127W 2x1.15A-DC110V DZD1-653 2X1838Nm-2x127W 2x1.15A-DC110V					

1:1	电机Motor			曳引轮 Sheave										代码 CODE
	额定载重 Load	额定速度 Speed	额定扭矩 Torque	额定功率 Power	额定转速 RPM	额定频率 Freq.	额定电流 Current	额定电压 Voltage	Ø	绳槽 Rope*	切口角 Angle*		槽距 Pitch	
	kg	m/s	Nm	kW	RPM	Hz	A	V	mm	n°	β	γ	mm	
MF600	800	1.0	1176	5.2	42	11.32	11.0	380	450	8xØ10	95°	35°	16	MF60080014501340
		1.5		7.8	64	16.98	16.5							MF60080014501.5340
		1.75		9.1	74	19.81	19.0							MF60080014501.75340
		2.0		10.5	85	22.64	21.8							MF60080014502340
		1.0	1254	5.2	40	10.67	11.3		480	7xØ12	18	MF60080014801340		
		1.5		7.8	60	16.00	17.0					MF60080014801.5340		
		1.75		9.1	70	18.67	19.6					MF60080014801.75340		
		2.0		10.5	80	21.33	22.5					MF60080014802340		
		1.0	1437	5.2	35	9.33	11.3		550	6xØ13	20	MF60080015501340		
		1.5		7.8	52	13.87	17.0					MF60080015501.5340		
		1.75		9.1	61	16.27	19.6					MF60080015501.75340		
		2.0		10.5	69	18.40	22.4					MF60080015502340		
	1000	1378	1.0	1378	6.1	42	11.32	14.0	450	9xØ10	16	MF600100014501340		
			1.5		9.2	64	16.98	21.3				MF600100014501.5340		
			1.75		10.7	74	19.81	24.4				MF600100014501.75340		
			2.0		12.3	85	22.64	28.3				MF600100014502340		
		1.0	1434	6.0	40	10.61	13.9	480	7xØ12	18	MF600100014801340			
		1.5		9.0	60	15.92	21.0				MF600100014801.5340			
		1.75		10.5	70	18.57	24.2				MF600100014801.75340			
		2.0		12.0	80	21.22	28.1				MF600100014802340			

2:1	电机Motor			曳引轮 Sheave										代码 CODE
	额定载重 Load	额定速度 Speed	额定扭矩 Torque	额定功率 Power	额定转速 RPM	额定频率 Freq.	额定电流 Current	额定电压 Voltage	Ø	绳槽 Rope*	切口角 Angle*		槽距 Pitch	
	kg	m/s	Nm	kW	RPM	Hz	A	V	mm	n°	β	γ	mm	
MF600	1600	1.0	1176	10.5	85	22.67	23.0	380	450	8xØ10	95°	35°	16	MF600160024501340
		1.5		15.6	127	33.87	34.5							MF600160024501.5340
		1.75		18.4	149	39.73	39.0							MF600160024501.75340
		2.0		21.0	170	45.33	44.0							MF600160024502340
		2.5	26.1	212	56.53	55.0	MF600160024502.5340							
		1.0	1470	13.1	85	22.67	29.5		9xØ10	20	MF600200024501340			
		1.5		19.5	127	33.87	45.0				MF600200024501.5340			
		1.75		23.0	149	39.73	48.5				MF600200024501.75340			
		2.0		26.3	170	45.33	60.0				MF600200024502340			
		1.0	1123	8.2	69	18.40	19.0		550	6xØ13	20	MF600125025501340		
		1.5		12.3	104	27.73	28.0					MF600125025501.5340		
		1.75		14.3	122	32.53	30.5					MF600125025501.75340		
	2.0	16.3		139	37.07	39.8	MF600125025502340							
	2.5	20.4	174	46.40	42.5	MF600125025502.5340								
	1.0	1213	8.8	69	18.40	20.4	550	6xØ13	20	MF600135025501340				
	1.5		13.3	104	27.73	31				MF600135025501.5340				
	1.75		15.4	122	32.53	33				MF600135025501.75340				
	2.0		17.6	139	37.07	39.8				MF600135025502340				
	2.5	22.1	174	46.40	46.2	MF600135025502.5340								
	1600	1437	1.0	1437	10.5	69	18.40	23.1	550	6xØ13	20	MF600160025501340		
			1.5		15.8	104	27.73	34.4				MF600160025501.5340		
			1.75		18.4	122	32.53	39.6				MF600160025501.75340		
			2.0		21.0	139	37.07	46.0				MF600160025502340		
			2.5		26.3	174	46.40	55.9				MF600160025502.5340		

1 - 数据如有更改，恕不另行通知
1 - Data are subject to change without prior notice

曳引轮绳槽数量和切口角可根据客户需求定制
* Rope groove number, β and γ angles can be customized upon request

	代码 - Code	配件 - Accessories
无机房 MRL	ACMF000010	远程松闸装置-7米松闸线 Remote Manual Release - 7 m wire
	ACMF000013	远程松闸装置-10米松闸线 Remote Manual Release - 10 m wire

MF600机器远程松闸装置只适用于以下工况 - Remote Manual Release in MF600 applicable to:
 · 载重1600kg配450mm曳引轮或以下 Ø450mm pulley with 1600kg load or less.
 · 载重1350kg配550mm曳引轮或以下 Ø550mm pulley with load 1350kg or less.
 · 载重2000kg配450mm曳引轮和载重1600kg配550mm曳引轮不适用远程松闸装置
 Ø450mm pulley with load 2000kg and Ø550mm pulley with load 1600kg can not use Manual Release Device.

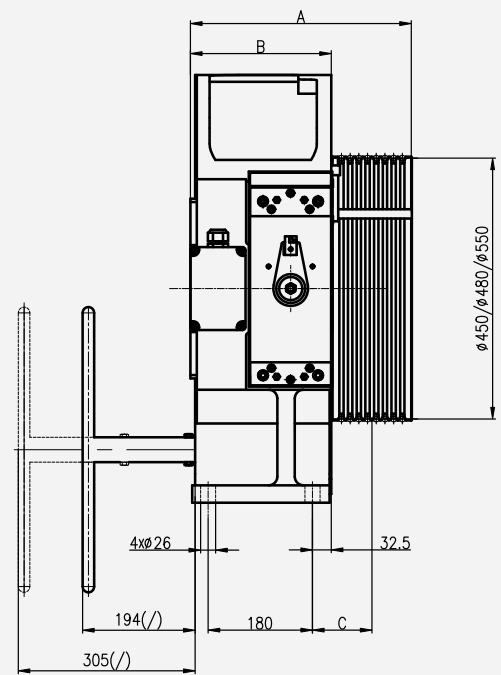
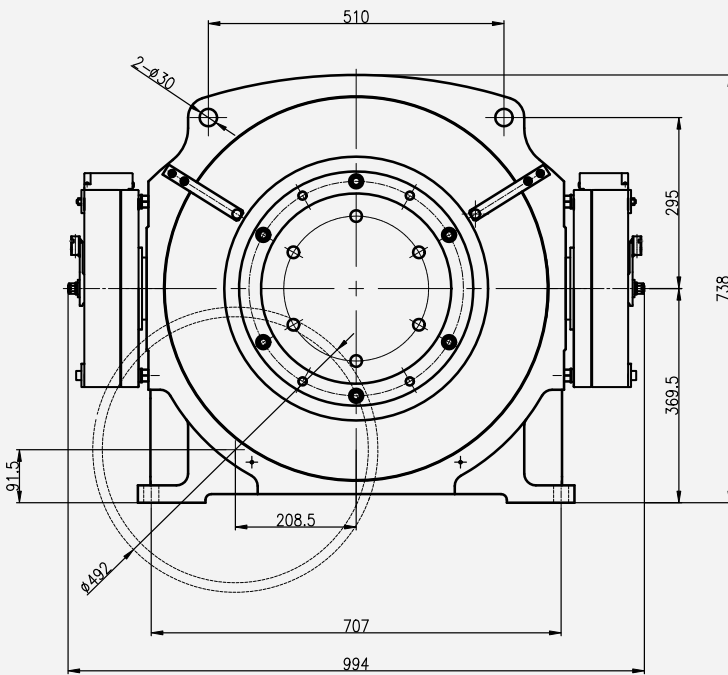

(/) Means without flywheel

2:1				
Pulley Diameter	Load	Size A	Size B	Size C
Ø450	1600kg or less	382	243	102.5
Ø550	1600kg or less			
Ø450	2000kg	408	253	110.5

1:1				
Pulley Diameter	Load	Size A	Size B	Size C
Ø450	800kg	382	243	102.5
Ø480/Ø550	800kg	408	253	110.5
Ø450/Ø480	1000kg			

